

The inlet valve usage

The inlet valves are installed to complete the system set-up and are connected to the universal rectangular backup box (Art. 1450.0 or Art. 1450.1 - see installation section). They faithfully reflect the shape, colour and finish of the domestic series chosen for the electrical system. Finish plates are not supplied by Sistem Air.

Connection to the micro line

The connection to the micro 12V line of the system is made in parallel via the supplied terminals.

For installation, simply attach the inlet valve to the rectangular backplate and secure it with the screws provided.

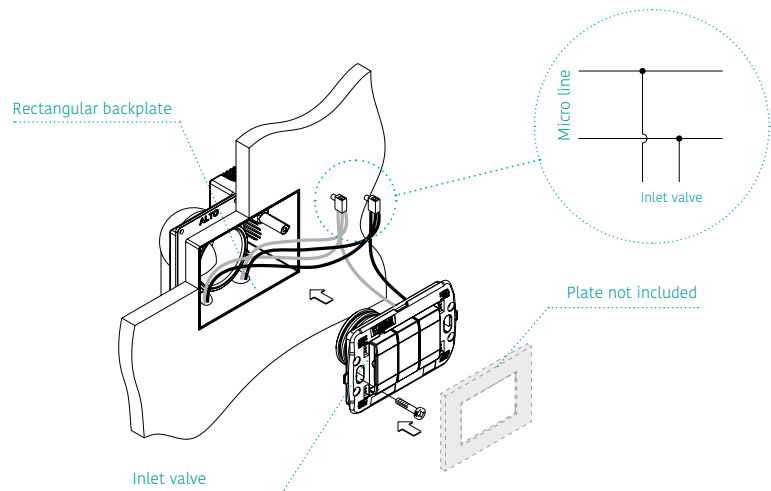

Activation of vacuum system

The inlet valves are equipped with a micro switch which, when the hose is inserted, activates the central vacuum cleaner for cleaning operations.

The microswitch is recognisable by the two golden balls on the inside of the inlet valve.

In the event of contact, it is absolutely safe, as it is low voltage and no components are connected to the mains.

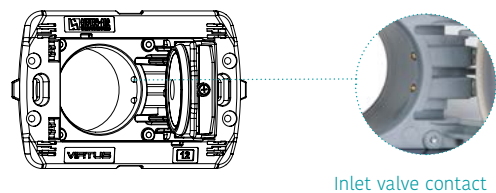
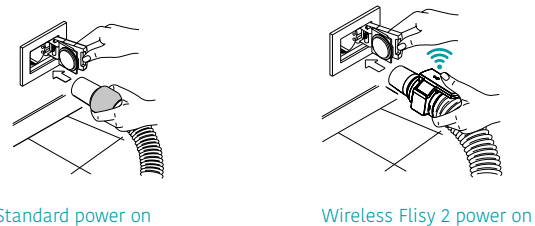

Standard switch-on



Standard cleaning hoses

The suction system is switched on when the hose is inserted into the inlet valve.

To switch off the system, simply pull out the pipe, interrupting suction.

Flisy wireless start-up



Flisy 2 wireless on/off cleaning hoses

The system starts when the hose is inserted in the inlet valves. For more details, see page 123.

The button on the handgrip can then be used to switch the vacuum on and off as required.

Rectangular inlet valves

VIRTUS

Virtus is the best line of inlet valves available on the market. Innovations designed by Sistem Air take the experience of using a central vacuum system to a higher level, guaranteed over time.

What makes Virtus inlet valves unique

Double seat for the o-ring

The double seat for the o-ring is designed to always allow a perfect seal with the backup box even when it is not perfectly flush with the plaster.

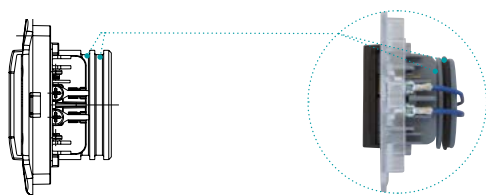

Frame Structure

The shape of the frame of the Virtus inlet valves is identical to that of the corresponding series, to ensure that the plate engages precisely and always stays in place.

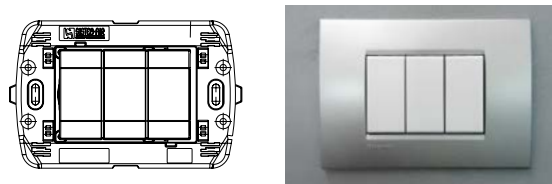

Beautiful and practical

The plugs blend in with the aesthetics of the environment and allow for the tilting opening of the inlet even when the system is under vacuum, in the case of several users at the same time.



Supporting structure

The four screws on the inlet body increase torsional rigidity, a necessary condition in cases where the socket bearing surface is uneven.

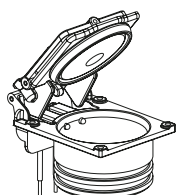

Ultra-fast connection

Equipped with 1 sq. mm wires, through the wiring terminals, they allow quick connection to the microswitch line of the central vacuum cleaner.

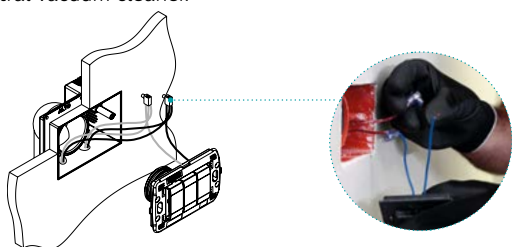

Mechanical resistance

Maximum mechanical strength thanks to the rounded walls and ribs on the back of the frame. Measures that strengthen the overall structure to the extreme.

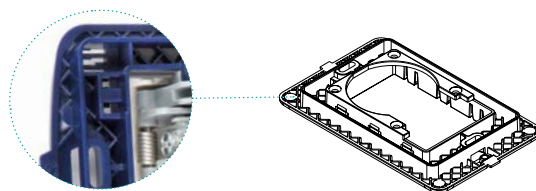

Zero vents, forever

The double taper gasket ensures that the grip is tight when closed. Made of SEBS rubber, it avoids the 'memory effect', remaining unchanged over the years.

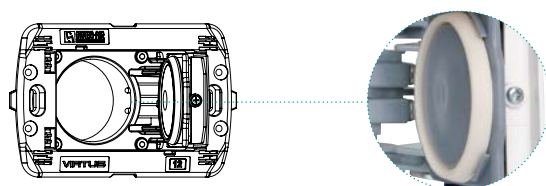

Compliant with everything

Virtus inlets work with all hoses on the market: with traditional fitting, electrified and with Flisy and Flisy 2 wireless on/off.

